

**TIG (GTAW), MIG (GMAW)**

**MACHINE TORCHES**

# MACHINE TORCHES: MIG/MAG - MG 505V

	<b>MG 505V</b>
Welding current, 60% load	500 A, CO2 450 A, 60% mix
Welding wire	0,8; 1,0; 1,2; 1,6
Hose package length	1 - 5 m

<b>Id. number</b>	<b>Product name</b>	
1	IG0MG0505811	torch tube MG 505S
3	IG0MG0505850	holder MG505S
6	IG0MG0505830	insulation
7	IG0MG0505870	cooling body II.
8	IG0MG0505830	tip adapter MG 505S
9	IG0MG0505716	gas nozzle MG 505V
10 - 13	IG0MG0505812*	contact nozzle (0,8; 1; 1,2; 1,6)

\*specify wire diameter when ordering

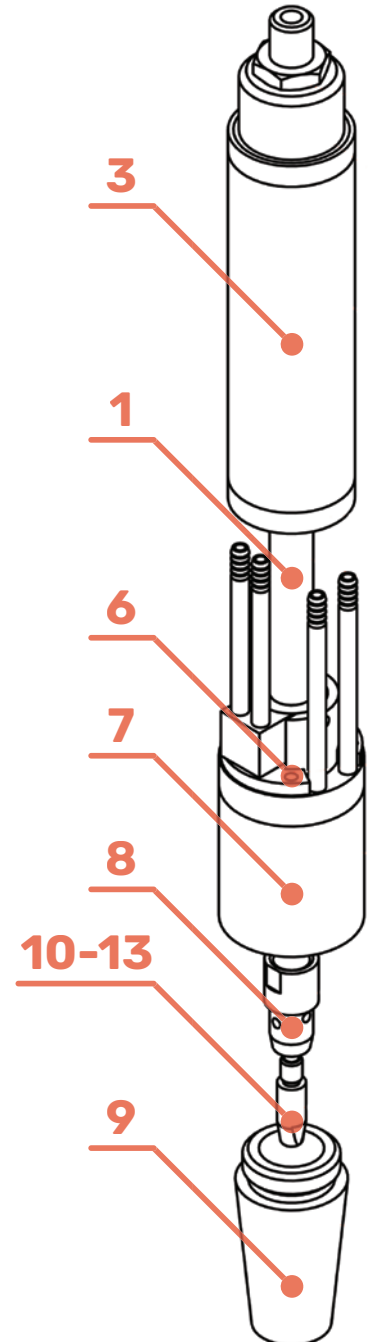

# MACHINE TORCHES: TIG

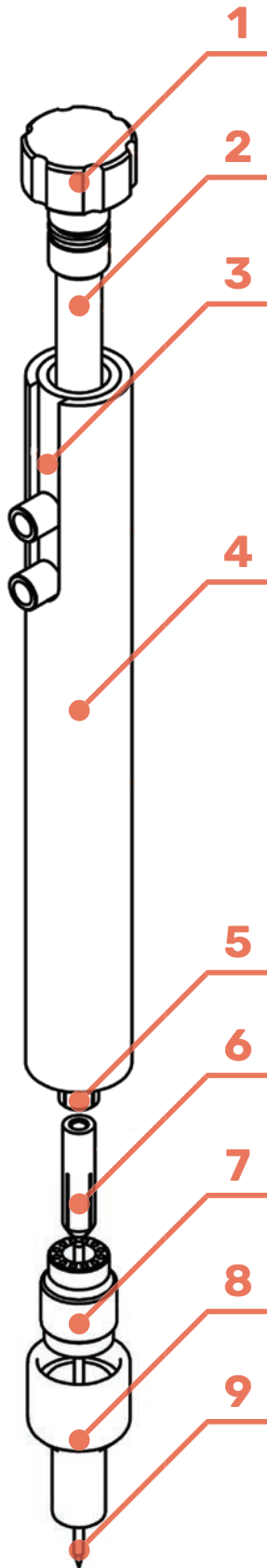

	<b>TG 202S</b>	<b>TG 302S</b>
Cooling	Air	Water
Max. welding current	200A	300A
Length	4 - 15 m	4 - 15 m

<b>Id. number</b>	<b>Product name</b>
1	IG4601017000 Torch cap TG 202/302
2	IG5700002000 Torch tube
3A	IG4701011000 torch body TG 202
3B	IG4701010000 torch body TG 302
4	IG570104000 insulation TG 202/302
5	IG5600355000 center part TG 202/302
6A	AI0470000760 collet TG 1,0
6B	AI0470000761 collet TG 1,6
6C	AI0470000762 collet TG 2,4
6D	AI0470000763 collet TG 3,6
7	IG0TG00000RP gas diffuser - collet body
8A	AI0470110300 ceramic nozzle 6/42
8B	AI047011064 ceramic nozzle 9/38
8C	AI0470110302 ceramic nozzle 9/50
8D	AI0470110303 ceramic nozzle 11/38
8E	AI0470110304 ceramic nozzle 13/38
9	wolfram electrode 1; 1,6; 2,4; 3,2

